

GEWERBEPARK MORGENSTERN | FRAUENFELD

TIMBER CONSTRUCTION AND SOLID CONSTRUCTION

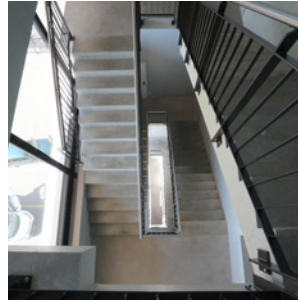

WIR GESTALTEN RÄUME
FÜR MENSCH + NATUR

TIEFBAU

LANDSCHAFTS-
ARCHITEKTUR

HOLZBAU

MASSIVBAU

BRANDSCHUTZ

Client

Landolt + Co. AG
Totalunternehmung RDN
Schaffhauserstrasse 10
8451 Kleinandelfingen

Year of construction

2013-2014

Construction costs

CHF 23 million

Planning contract

- Conceptual design for building construction
- Submission reinforced concrete
- Structural design, structural concept and engineering work
- Implementation planning
- Construction supervision

Project description

- Industrial park with storage, cargo handling and exhibition areas on three floors
- Extensive office and administration wing in timber construction
- Two-storey subterranean car park / garage
- Exposed concrete construction
- Skeleton design for variable flexible usage
- Combined construction in wood and concrete

